

SURVEYED FOR  
 PROPERTY LOCATED AT BRIDGEHAMPTON  
 TOWN OF SOUTHAMPTON  
 SUFFOLK COUNTY, NEW YORK  
 S.C.T.M. # 900-087-02-40.3  
 AREA = 295,811 SF = 6.791 AC  
 AREA EXCLUDING ACCESS STRIP = 290,786 SF = 6.676 AC

SEE REVISED MINOR SUBDIVISION OF  
 ESTATE OF WILLIAM MUSNICKI  
 MINOR SUBDIVISION MAP NO: 903  
 ALSO MINOR SUBDIVISION MAP NO: 547

NOTE: THE EXISTENCE OF RIGHT OF WAYS,  
 WETLANDS AND/OR EASEMENTS OF RECORD  
 IF ANY, NOT SHOWN ARE NOT GUARANTEED.

MAP-MAGNETIC

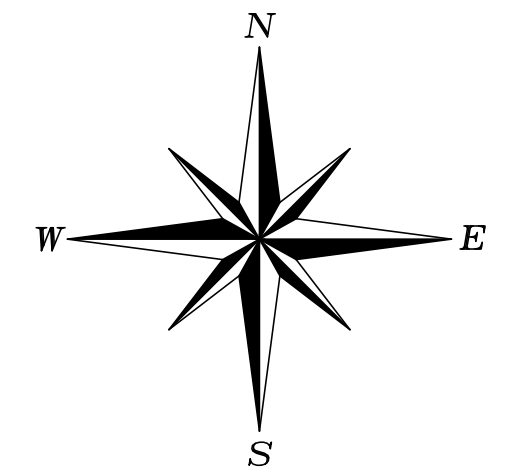

SCALE: 1"=60'



TRUE NORTH

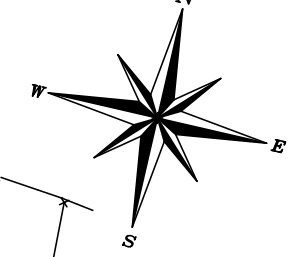

HALSEY LANE

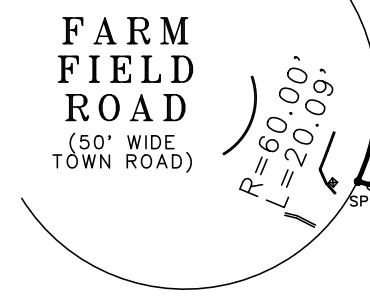

PROPERTY ZONED R-80  
 PROPERTY LOCATED WITHIN AGRICULTURAL  
 OVERLAY DISTRICT  
 PROPERTY LOCATED WITHIN  
 FEMA FLOOD ZONE "X"

UNAUTHORIZED ALTERATION OR ADDITION TO THIS SURVEY IS A VIOLATION  
 OF SECTION 7209 OF THE NEW YORK STATE EDUCATION LAW.

COPIES OF THIS SURVEY MAP NOT BEARING THE LAND SURVEYORS INKED  
 OR EMBOSSED SEAL SHALL NOT BE CONSIDERED TO BE A VALID TRUE COPY.

GUARANTEES OR CERTIFICATIONS INDICATED HEREON SHALL RUN ONLY TO  
 THE PERSON FOR WHOM THE SURVEY IS PREPARED, AND ON HIS BEHALF TO  
 THE TITLE COMPANY, GOVERNMENTAL AGENCY AND LENDING INSTITUTION  
 LISTED HEREON, AND TO THE ASSIGNEES OF THE LENDING INSTITUTION.  
 GUARANTEES OR CERTIFICATIONS ARE NOT TRANSFERABLE TO ADDITIONAL  
 INSTITUTIONS OR SUBSEQUENT OWNERS.

PREPARED FOR:  
 MUSNICKI LIMITED PARTNERSHIP

*John Bufala*

26466



SURVEYED BY:  
 BARYLSKI LAND SURVEYING  
 2320 MAIN ST. P.O. BOX 1302  
 NEWMAN VILLAGE CONDO.  
 BRIDGEHAMPTON, NEW YORK  
 (631-537-7944)  
 MARCH 19, 2025